

OCT. 2016		CUT LIST - ROCKER ASSEMBLY					
		IMPERIAL			METRIC		
PART	QTY	THK	W	L	THK	W	L
ARM	2	7/8"	4 5/8"	24"	22	117.5	610
ROCKER	2	1 3/4"	5 1/2"	30"	44.5	140	762
TOP SIDE RAIL	2	7/8"	3 1/4"	10 1/4"	22	82.5	476
LOWER SIDE RAIL	2	7/8"	1 1/4"	18 3/4"	22	32	476

Design by Paul Sellers – Drawing by Gregory Merritt

Page 1 of 3

© 2016 Woodworking Masterclasses

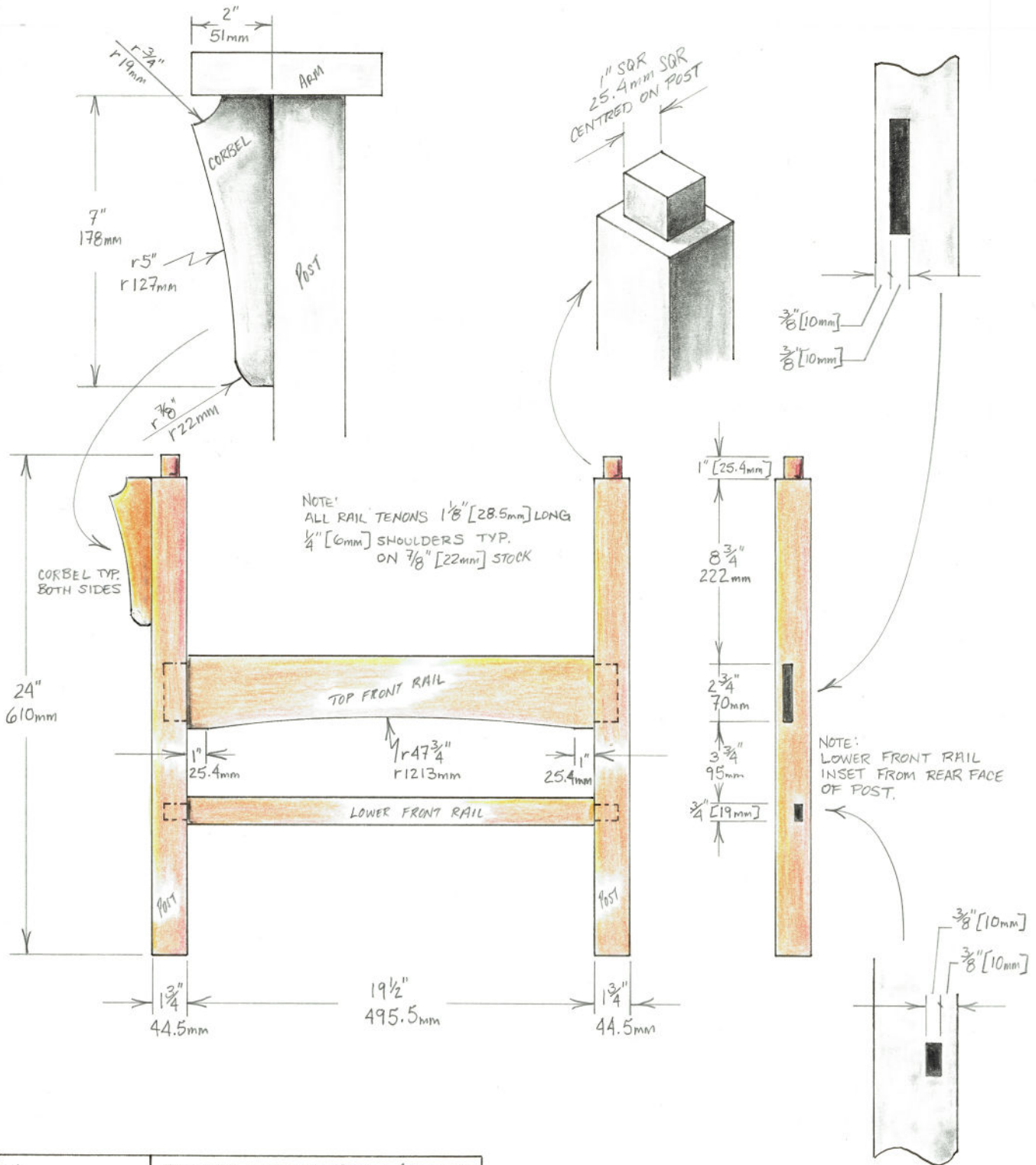

OCT. 2016		CUT LIST - FRONT FRAME ASSEMBLY					
		IMPERIAL			METRIC		
PART	QTY	THK	W	L	THK	W	L
POST (LEG)	2	$1\frac{3}{4}$ "	$1\frac{3}{4}$ "	24"	44.5	44.5	610
TOP FRONT RAIL	1	$\frac{7}{8}$ "	$3\frac{1}{4}$ "	$21\frac{3}{4}$ "	22	82.5	552.5
LOWER FRONT RAIL	1	$\frac{7}{8}$ "	$1\frac{1}{4}$ "	$21\frac{3}{4}$ "	22	32	552.5
CORBEL	2	$\frac{7}{8}$ "	2"	7"	22	51	178

Design by Paul Sellers – Drawing by Gregory Merritt

Page 2 of 3

© 2016 Woodworking Masterclasses

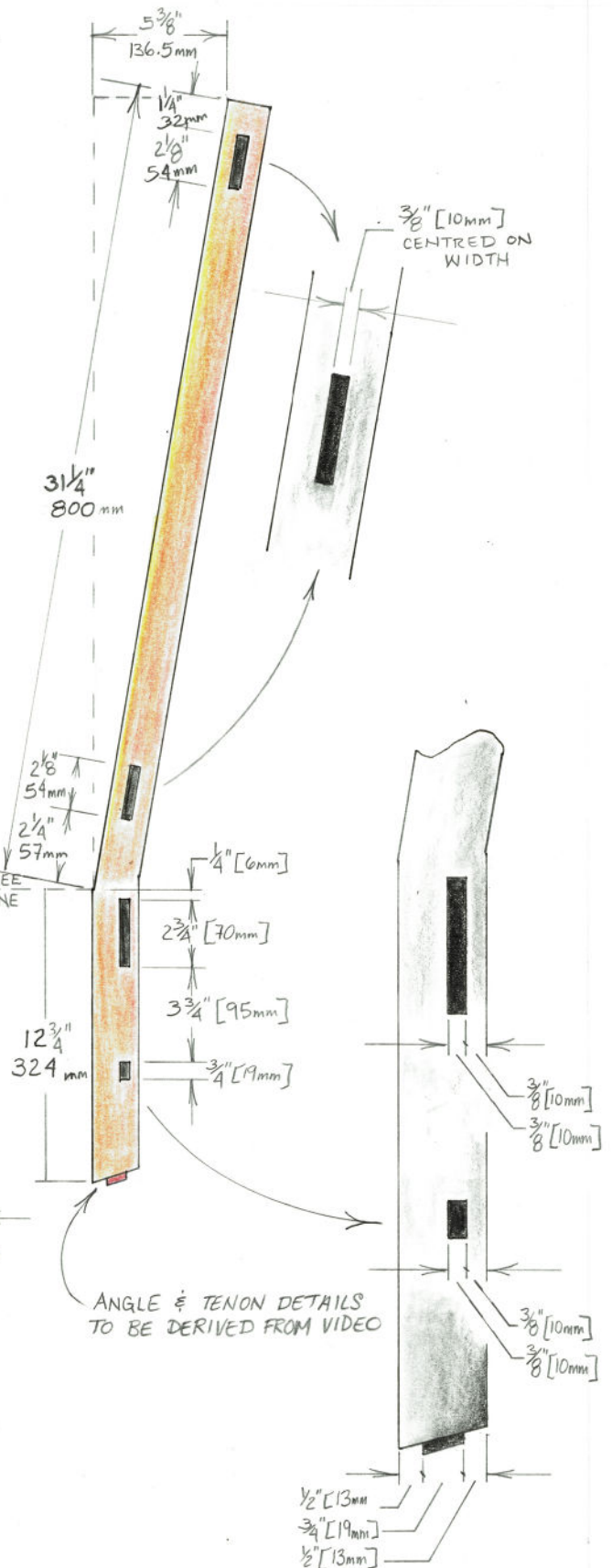
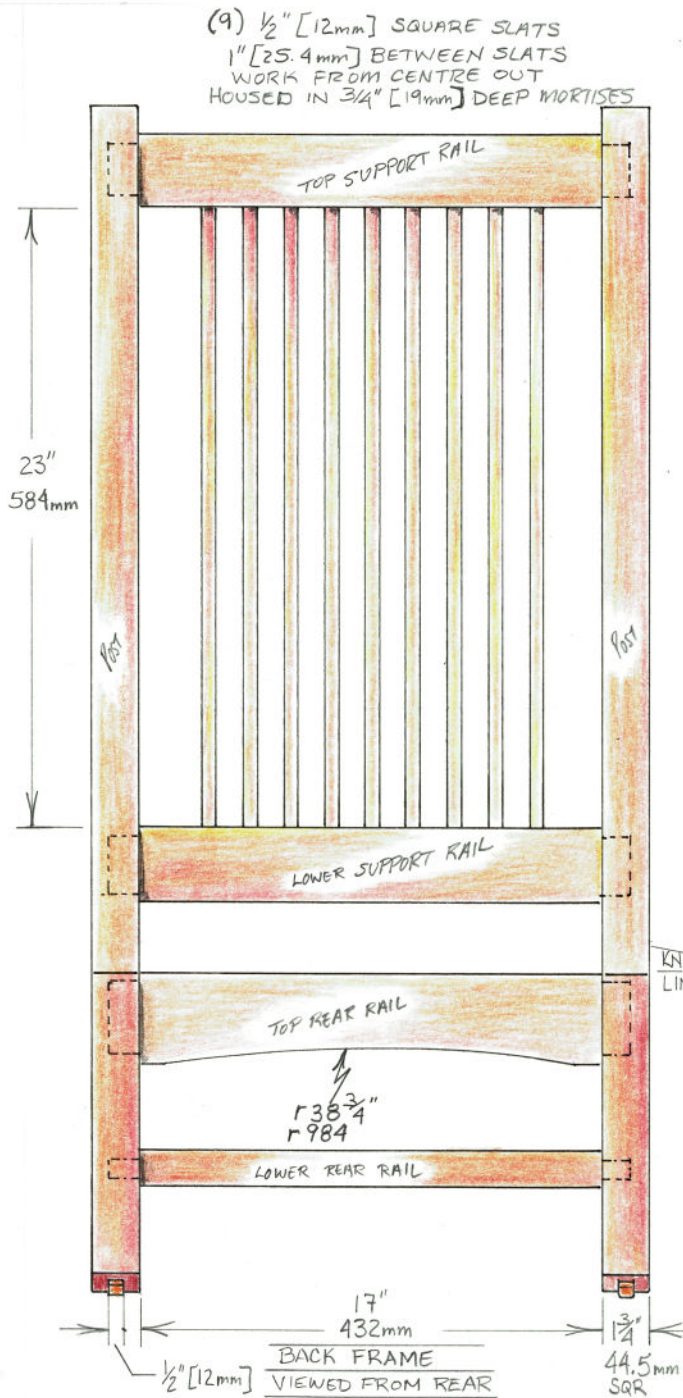

OCT 2016		CUT LIST - BACK FRAME ASSEMBLY					
		IMPERIAL			METRIC		
PARTS	QTY	THK	W	L	THK	W	L
POST (LEG)	1	1 3/4"	7 1/2"	45"	44.5	190.5	1143
TOP SUPPORT RAIL	1	1 3/4"	2 5/8"	19 1/4"	44.5	67	489
LOWER SUPPORT RAIL	1	1 3/4"	2 5/8"	19 1/4"	44.5	67	489
TOP REAR RAIL	1	7/8"	3 1/4"	19 1/4"	22	82.5	489
LOWER REAR RAIL	1	7/8"	1 1/4"	19 1/4"	22	32	489
SLATS	9	9/16"	9/16"	24 1/2"	14	14	622